

# Stinger LED Switch Replacement

## REPLACEMENT

### REMOVAL

1. Remove facecap and tailcap (or tailcap/switch assembly).

2. Slide battery out of flashlight body.

3. Use a pair of snap ring pliers (or the Stinger switch module pliers, p/n 750163) to unscrew the retainer from the flashlight body.

4. Use a Philip's screwdriver to remove the two charge screws (located opposite the switch) that secure the charge plate to the flashlight.

5. Reinsert the battery and use it to push the switch module assembly free from the flashlight.

6. Push the switchboot down and into the body to remove it from the flashlight.

Discard the original switch module and retainer.

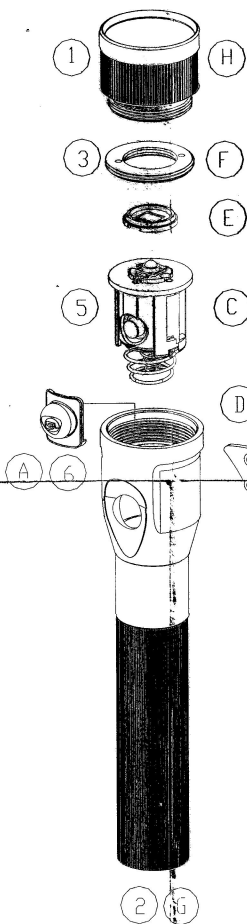

A. Insert the new switchboot (SL logo oriented as shown) into the opening in flashlight barrel.

B. Replace insulating label (if needed/Not Shown) located at the top of the barrel opposite the switch opening.  
(The label prevents the triangular switch spring from contacting the barrel.)

C. Insert the new switch module into body and align switch so that the two mounting holes of the switch module align with the mounting holes for the charge screws.

D. Insert the two charge screws through the charge plate and secure them in the mounting holes in the switch module.

E. Place the centering disk onto the switch module with the small alignment post down and insert it into the open hole located on the LED module opposite the red and black wires.

F. Insert the new retainer into the head of the flashlight align it with the centering disk and tighten the retainer with the snap ring pliers.

G. Insert the battery into the flashlight body (double contacts toward head).

H. Reinstall the facecap and secure the tailcap.